



Exhaust Pressure Transmitter Installation on EDS Pump

INSTRUCTION MANUAL

PART NUMBER

A41894001

Copyright notice

©Edwards Limited 2024. All rights reserved.

Published: 11/29/2024

Associated publications

Publication title	Publication number	Link
Dry vacuum pumps (ATEX) EDS 200, EDS 300	A41801880	https://4vac.io/x2em2l
Chemical (ATEX) Dry Vacuum Pumps EDS 480	A41803880	https://4vac.io/04b5ca

Trademark credit

Edwards and the Edwards logo are trademarks of Edwards Limited, Innovation Drive, Burgess Hill, West Sussex, UK, RH15 9TW

Disclaimer

The content of this manual may change from time to time without notice. We accept no liability for any errors that may appear in this manual nor do we make any expressed or implied warranties regarding the content. As far as practical we have ensured that the products have been designed and constructed to be safe and without risks when properly installed and used in accordance with their operating instructions.

We accept no liability for loss of profit, loss of market or any other indirect or consequential loss whatsoever.

Product warranty and limit of liability are dealt with in our standard terms and conditions of sale or negotiated contract under which this document is supplied.

You must use this product as described in this manual. Read the manual before you install, operate, or maintain the product. For manual enquiries, email manuals@edwardsvacuum.com.

Contents

1. Safety and compliance.	4
1.1 Definition of Warnings and Cautions.	4
1.2 Trained personnel	4
1.3 Safety symbols.	5
2. Description.	6
3. Unpack and inspect.	6
4. Installation.	6
4.1 Installation safety.	6
4.2 Install the exhaust pressure transmitter.	7
5. Storage.	10
6. Service.	10
6.1 Return the equipment or components for service	10

1. Safety and compliance

For safe operation from the start, read these instructions carefully before you install or commission the equipment and keep them safe for future use. Read all the safety instructions in this section and the rest of this manual carefully and make sure that you obey these instructions.

The instruction manual is an important safety document that we often deliver digitally. It is your responsibility to keep the instruction manual available and visible while working with the equipment. Please download the digital version of the instruction manual for use on your device or print it if a device will not be available.

1.1 Definition of Warnings and Cautions

Important safety information is highlighted as warning and caution instructions which are defined as follows. Different symbols are used according to the type of hazard.

WARNING:

If you do not obey a warning, there is a risk of injury or death.

CAUTION:

If you do not obey a caution, there is a risk of minor injury, damage to equipment, related equipment or process.

NOTICE:

Information about properties or instructions for an action which, if ignored, will cause damage to the equipment.

We reserve the right to change the design and the stated data. The illustrations are not binding.

1.2 Trained personnel







For the operation of this equipment “trained personnel” are:

- skilled workers with knowledge in the fields of mechanics, electrical engineering, pollution abatement and vacuum technology and
- personnel specially trained for the operation of vacuum pumps

1.3 Safety symbols

The safety symbols on the products show the areas where care and attention is necessary.

The safety symbols that we use on the product or in the product documentation have the following meanings:

	<p>Warning/Caution</p> <p>Risk of injury and/or damage to equipment. An appropriate safety instruction must be followed or a potential hazard exists.</p>
	<p>Warning - Automatic start up</p> <p>Risk of injury. The equipment can be started remotely and without warning.</p>
	<p>Warning - Dangerous voltage</p> <p>Risk of injury. Identifies possible sources of hazardous electrical shock.</p>
	<p>Warning - Hot surfaces</p> <p>Risk of injury. Identifies a surface capable of inflicting burns through contact.</p>
	<p>Warning - Pressurised</p> <p>Risk of injury or damage to equipment. Identifies equipment containing pressurised gases or liquids.</p>
	<p>Warning - Vacuum hazard</p> <p>Risk of injury. Identifies the source of a dangerous vacuum.</p>
	<p>Warning - Overhead or Suspended load</p> <p>Risk of injury or damage to equipment. Identifies an area where overhead or suspended items may lower or fall.</p>
	<p>Mandatory action symbol</p> <p>Failure to comply with this action may result in injury or damage to equipment.</p>
	<p>Mandatory - Read the manual</p> <p>Failure to comply with this action may result in injury or damage to equipment.</p>
	<p>Warning - Use protective equipment</p> <p>Risk of injury. Use appropriate Personal Protective Equipment (PPE) when performing the task.</p>

2. Description

This manual provides installation instructions for the EDS vacuum pump exhaust pressure transmitter. The exhaust pressure transmitter must be installed as described in this manual.

This manual must be used in conjunction with the EDS pump manuals. Read the instruction manuals before you install or use the exhaust pressure transmitter.

3. Unpack and inspect

Remove all the packaging materials and check the exhaust pressure transmitter for damages.

Do not use the exhaust pressure transmitter if it is damaged. If it is not to be used immediately, store as described in [Storage](#) on page 10.

4. Installation

4.1 Installation safety



WARNING: HAZARDOUS VOLTAGE

Risk of injury or damage to equipment. Make sure that you switch off the pump and isolate the controller from the power supply.



WARNING: HOT SURFACES

Risk of burns. Do not touch the pump inlet, exhaust or check valve while the pump is running. The high temperatures of pump parts can cause harm. Let the pump cool before you start working on the pump.



WARNING: PRESSURIZED PIPING

Risk of injury. Do not operate the system with the exhaust pipeline blocked. The high pressure inside the exhaust pipe can cause harm. Ensure that the exhaust is vented before start working on the pump.

Before you install the exhaust pressure transmitter on the pump, make sure that:

- the dry pumping system and other components in the process system is isolated from the electrical supply to prevent accidental operation.
- the exhaust is cooled to a safe temperature before you do the maintenance. Do not touch the exhaust pipe when it is hot.
- the pump is secured correctly before the exhaust pressure transmitter is fitted. Refer to the pump manual for details.
- the pipe work connected is self supporting and must not create any misalignment or stress at the connection point to the exhaust pressure transmitter.
- the operating procedures described in the EDS pump instruction manual are obeyed.

4.2 Install the exhaust pressure transmitter

Refer to manual of the sensor for more information.

To install the exhaust pressure transmitter on the EDS pump, do the steps that follows:

1. Remove the plug (1) from the pump.

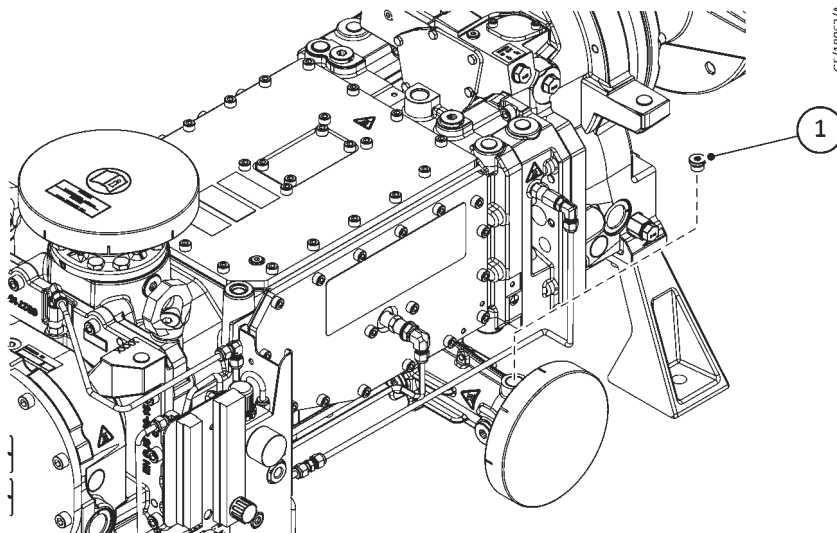

GE/18063/A

2. Install the exhaust connector (2) on the pump. Torque tighten the connector (2) to 35 ± 5 Nm.

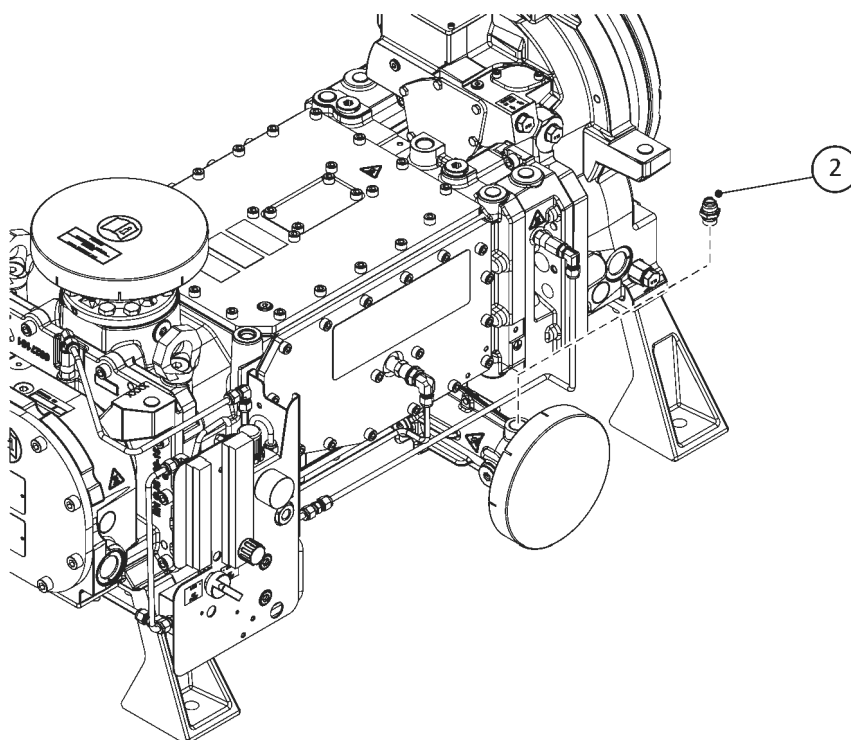

GE/18063/A

3. Install the connector (4) on the exhaust pressure transmitter (3). Torque tighten the connector (4) to 35 ± 5 Nm.

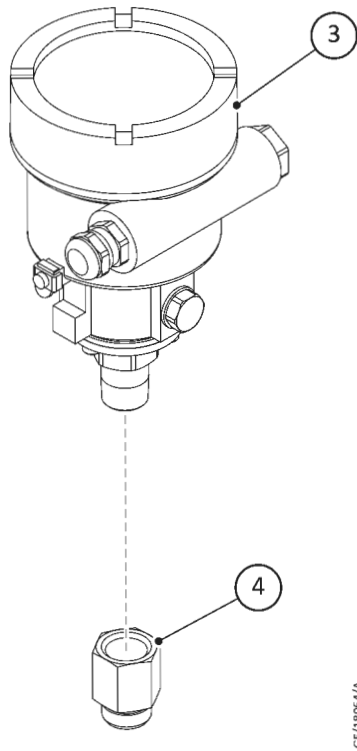

4. Connect one end of the pipe (5) to the exhaust connector (2).

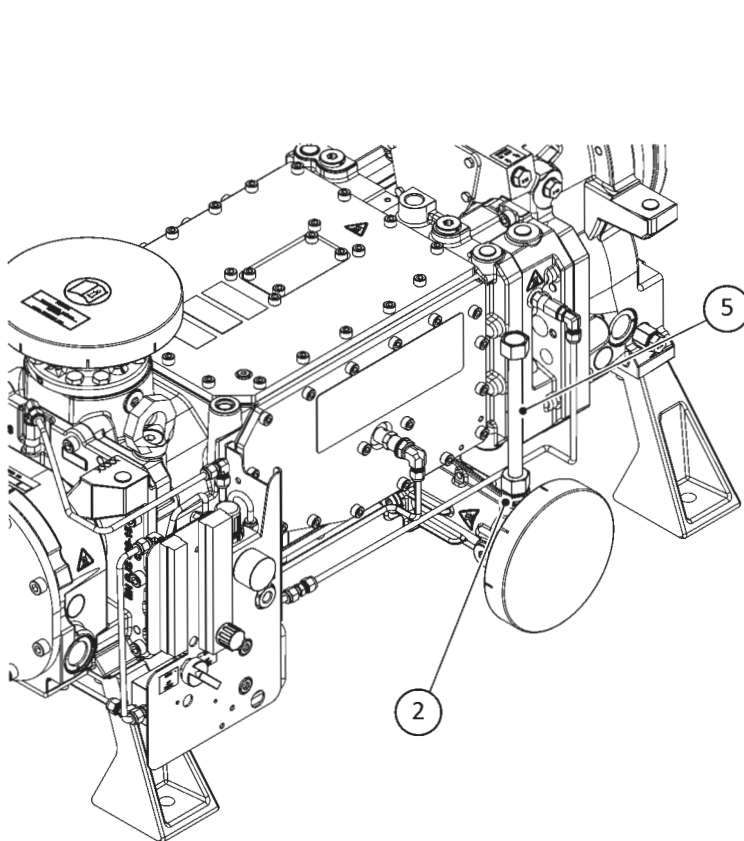

5. Install the exhaust pressure transmitter (3) sub assembly to other end of the pipe (5).

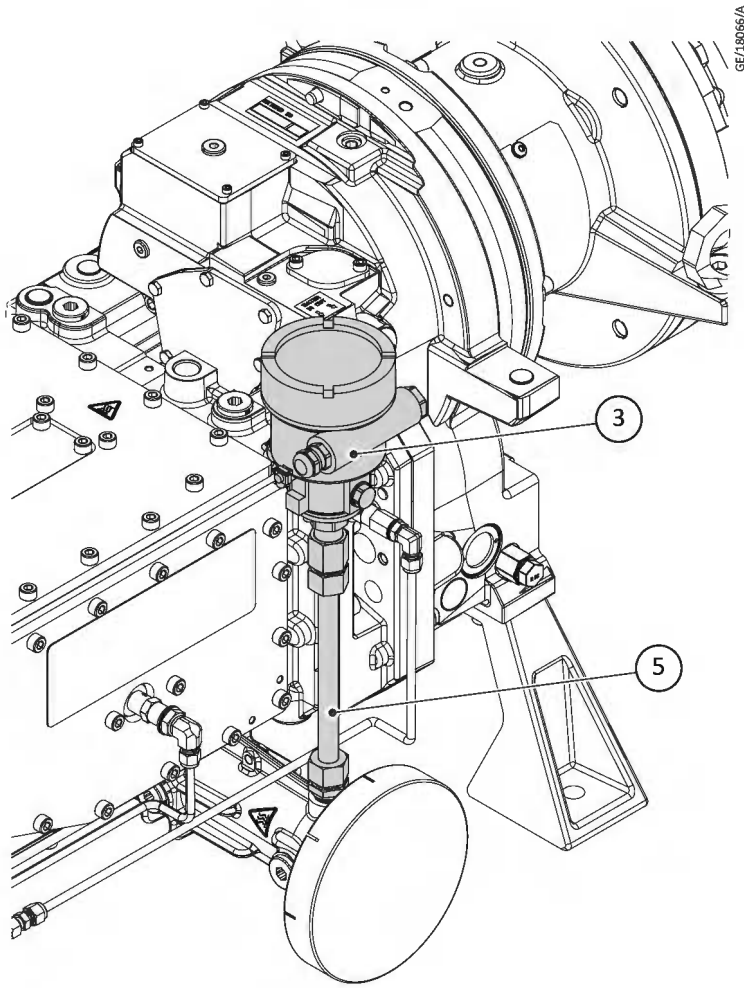

6. Apply the oil provided to the threads of the fitting and union nut as shown in the illustration. Make sure that the threads are lightly wet.

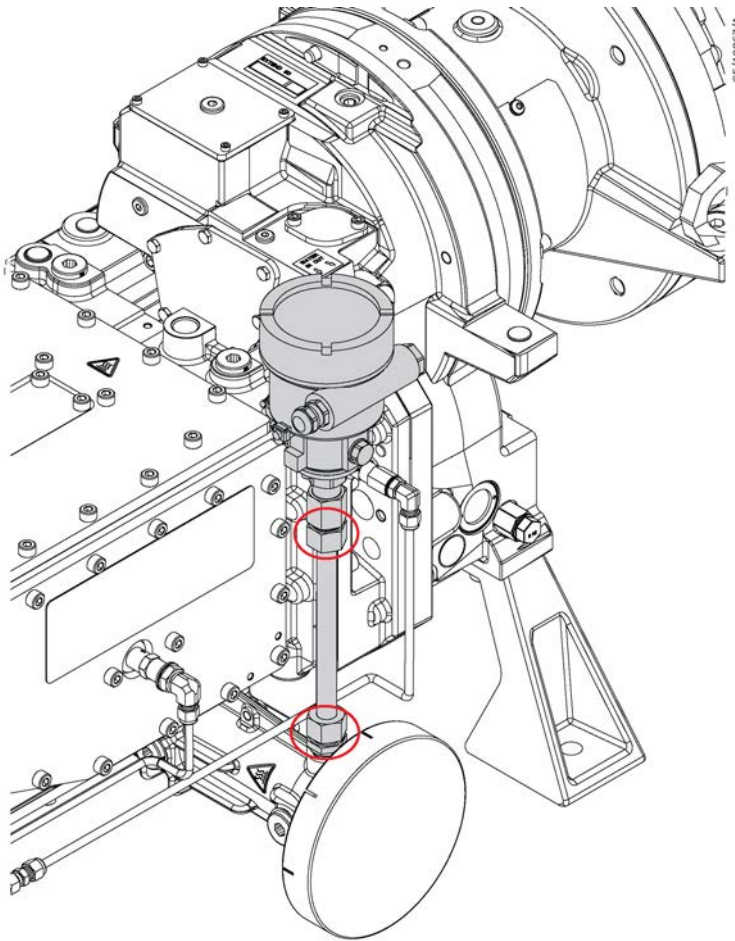

7. Tighten the union nut onto the fitting body until you feel a noticeable increase in resistance. After this point, turn the fitting a maximum of 1/4 turn further to fully seal it.

5. Storage

If the exhaust pressure transmitter is not used immediately:

- Clean the exhaust pressure transmitter.
- Protect the flange face and place the exhaust pressure transmitter in a sealed polythene bag.
- Store in a cool and dry place.

6. Service

6.1 Return the equipment or components for service

Before you send your equipment to us for service or for any other reason, you must complete a Declaration of Contamination Form. The form tells us if any substances found in the equipment are hazardous, which is important for the safety of our employees and

all other people involved in the service of your equipment. The hazard information also lets us select the correct procedures to service your equipment.

If you are returning equipment note the following:

- If the equipment is configured to suit the application, make a record of the configuration before returning it. All replacement equipment will be supplied with default factory settings.
- Do not return equipment with accessories fitted. Remove all accessories and retain them for future use.
- The instruction in the returns procedure to drain all fluids does not apply to the lubricant in pump oil reservoirs.

Download the latest documents from edwardsvacuum.com/HSForms/, follow the procedure in HS1, fill in the electronic HS2 form, print it, sign it, and return the signed copy to us.



NOTICE:

If we do not receive a completed form, your equipment cannot be serviced.

